



**ELECTRICAL  
INDUSTRIES**  
GROUP



**Lighting**  
**CATALOGUE**





## Table of CONTENTS

<b>SGT SERIES</b>	
Shallow Recessed Troffer .....	<b>04</b>
<b>DHGM SERIES</b>	
2x2 Deep Parabolic Lay-in Troffer .....	<b>06</b>
<b>DTGM SERIES</b>	
Deep Parabolic Lay-in Troffer .....	<b>08</b>
<b>DID C.B. SERIES</b>	
Direct Indirect Recessed Troffer .....	<b>10</b>
<b>SES SERIES</b>	
Swivel End Strip Lighting .....	<b>12</b>
<b>SLS SERIES</b>	
Slim Line Strip Lighting .....	<b>14</b>
<b>BP SERIES</b>	
Surface Mounted Wrap Fixture .....	<b>16</b>
<b>TWIN WRAP SERIES</b>	
9" Wraparound .....	<b>18</b>
<b>WRAP 4 TUBE SERIES</b>	
15" Wraparound .....	<b>20</b>
<b>DEEP WRAP SERIES</b>	
Deep Profile Wraparound Fixture .....	<b>22</b>
<b>VP SERIES</b>	
Vapor Proof .....	<b>24</b>
<b>VPP SERIES</b>	
Vapor Proof Premium .....	<b>26</b>
<b>VPWL</b>	
Vapor Proof Wet Location .....	<b>28</b>
<b>LFHBSES</b>	
SES Fluorescent High Bay .....	<b>30</b>



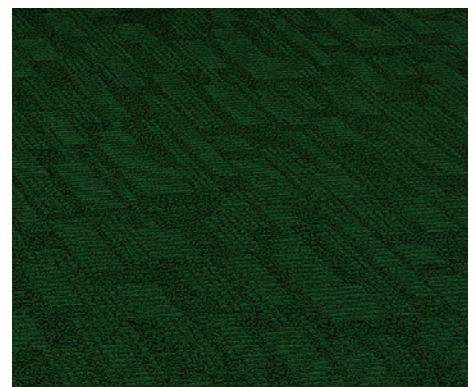
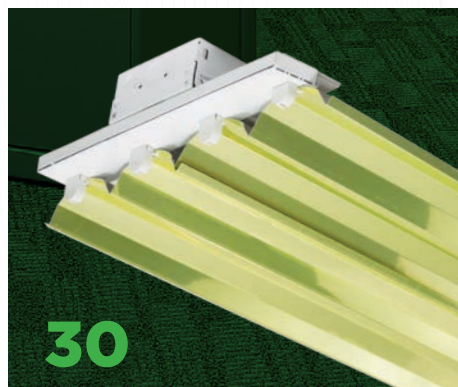
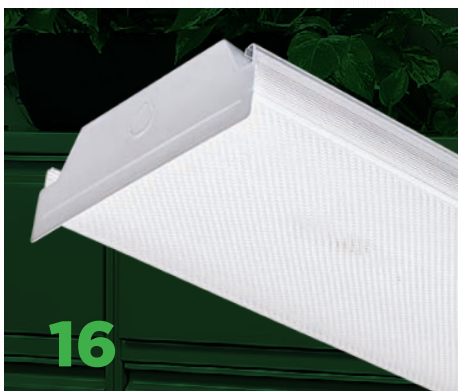
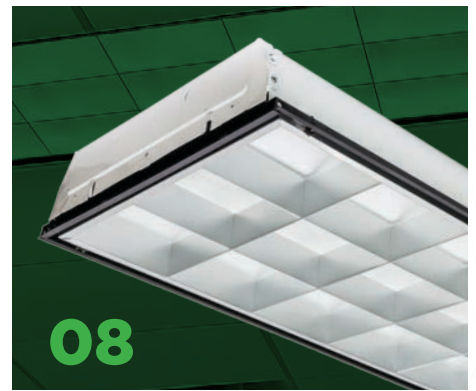
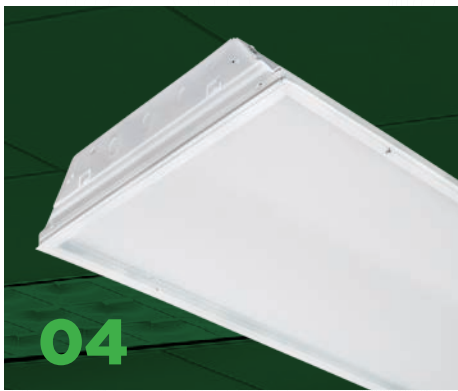



## Shallow Recessed Troffer

## Applications

Premium quality low profile troffer with an al-most limitless range of applications. Ideal for all commercial and industrial buildings requir-ing general illumination with recessed configu-rations.

## SPECIFICATIONS

Housing is die-formed and embossed from cold rolled steel. Finish is high reflectance P3 - Post Powder Paint. Wiring access plate and knockouts are provided on back of housing allowing for flexibility. Frame hinges downward on either side and is held in the closed position by two posi-tive cam latches. Knockouts are provided on ends for continuous wiring. Listed by and bears UL label.

## Features &amp; Benefits

- UL listed for damp location
- >90% reflectivity
- Corrosion and scratch resistant
- Smooth edges for easy handling
- Available in multiple lamp configurations
- Shallow design specifically for T5 or T8 lamps
- Ends are secured by snap-in interlock
- Clear 0.100 acrylic prismatic lens is standard
- Exclusive "Light Lock" frame reduces light leaks
- Flush steel door with rotary action cam latches or hinges from either side for easy re-lamping
- Easy access plate for quick wiring
- Available in multiple lamp configurations
- Equipped with Integral Earthquake Clips
- Every fixture is individually testeda
- Available in T8, T5, T5HO and LED versions



## ORDERING DATA

Item #	Description	Old Code	Nominal Dimensions	Lamp Type/Wattage	Input Voltage	Tubes Included	Diffuser/Lens Type
12580300000	SGT/3014/EB/UNV/T5	20663	2' x 2'	T5-14W	120-277 VOLTS AC	No	Acrylic Prismatic
12583000000	SGT/2028/EB/UNV/T5 TUBE	20665	2' x 4'	T5-28W	120-277 VOLTS AC	No	Acrylic Prismatic
12581900000	SGT/2028/EB/UNV/T5/DIM	20690	2' x 4'	T5-28W	120-277 VOLTS AC	No	Acrylic Prismatic
12580100000	SGT/3028/EB/UNV/T5 TUBE	20661	2' x 4'	T5-28W	120-277 VOLTS AC	No	Acrylic Prismatic
12580700000	SGT/4054/EB/UNV	20669	2' x 4'	T5-54W	120-277 VOLTS AC	No	Acrylic Prismatic
12579200000	SGT/3017/EB/UNV BOX	20646	2' x 2'	T8-17W	120-277 VOLTS AC	No	Acrylic Prismatic
12579100000	SGT/4017/EB/UNV BOX	20645	2' x 2'	T8-17W	120-277 VOLTS AC	No	Acrylic Prismatic
12581000000	SGT/2032/EB/UNV	20672	2' x 4'	T8-32W	120-277 VOLTS AC	No	Acrylic Prismatic
12580800000	SGT/2032/EB/UNV	20670	2' x 4'	T8-32W	120-277 VOLTS AC	No	Acrylic Prismatic
12579800000	SGT/3032/EB/UNV/BOX	20655	2' x 4'	T8-32W	120-277 VOLTS AC	No	Acrylic Prismatic
12579400000	SGT/4032/EB/UNV	20651	2' x 4'	T8-32W	120-277 VOLTS AC	No	Acrylic Prismatic
12579600000	SGT/4032/EB/UNV C/W 78 CELL	20653	2' x 4'	T8-32W	120-277 VOLTS AC	No	78 Cell Parabolic
12573800000	SGT/4032/EB/UNV/AED	20651AED	2' x 4'	T8-32W	120-277 VOLTS AC	No	Acrylic Eggcrate
12574000000	SGT/4032/EB/UNV/SPD	20651SPD	2' x 4'	T8-32W	120-277 VOLTS AC	No	Chrome Eggcrate
12582700000	SGT/2020/LED/65/1800LM		2' x 4'	20W-LED-1800-LUMENS-6500K	120-277 VOLTS AC	Yes	Acrylic Prismatic
12582800000	SGT/3020/LED/65/1800LM		2' x 4'	20W-LED-1800-LUMENS-6500K	120-277 VOLTS AC	Yes	Acrylic Prismatic
12582900000	SGT/4020/LED/65/1800LM		2' x 4'	20W-LED-1800-LUMENS-6500K	120-277 VOLTS AC	Yes	Acrylic Prismatic
12582200000	SGT/3010/LED/65/900LM		2' x 2'	LED-10W-900 LUMEN 6500K	120-277 VOLTS AC	Yes	Acrylic Prismatic
12582300000	SGT/4010/LED/65/900LM		2' x 2'	LED-10W-900 LUMEN 6500K	120-277 VOLTS AC	Yes	Acrylic Prismatic
12582400000	SGT/2020/LED/40/1800LM		2' x 4'	LED-20W-1800-LUMENS-4000K	120-277 VOLTS AC	Yes	Acrylic Prismatic
12582500000	SGT/3020/LED/40/1800LM		2' x 4'	LED-20W-1800-LUMENS-4000K	120-277 VOLTS AC	Yes	Acrylic Prismatic
12582600000	SGT/4020/LED/40/1800LM		2' x 4'	LED-20W-1800-LUMENS-4000K	120-277 VOLTS AC	Yes	Acrylic Prismatic





## DIMENSIONS

MODEL CONFIGURATION	A	B
2' x 2'	22 3/4"	23 7/8"
2' x 4'	22 3/4"	47 3/4"

## BACKPLAN

2X4 BACKPLAN

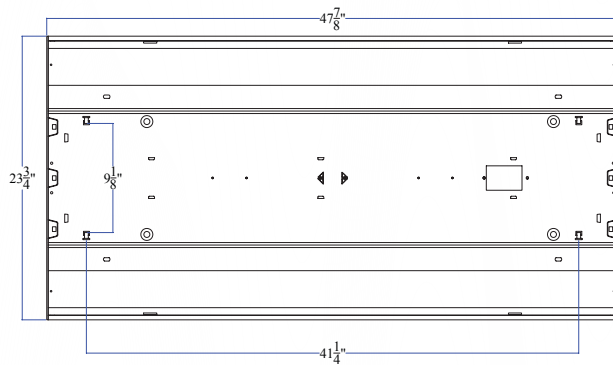

1X4 BACKPLAN

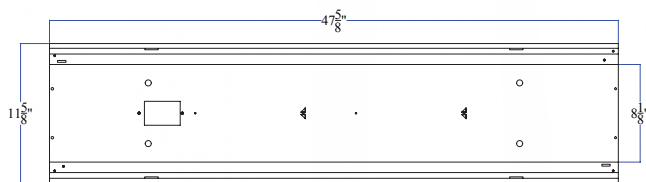

2X2 3 LAMP BACKPLAN

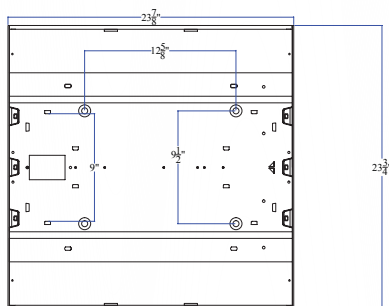

2X2 2 OR 4 LAMP BACKPLAN

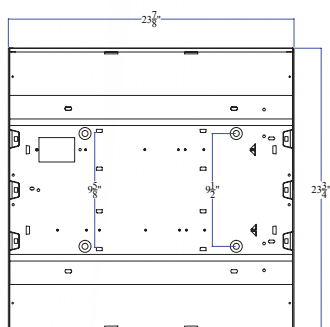

## CROSS SECTION

TWO LAMP

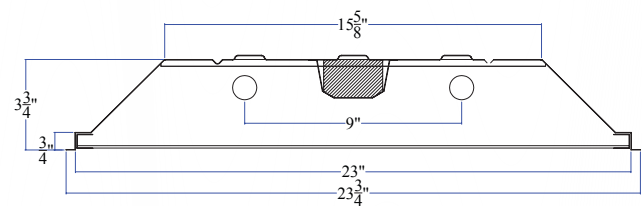

THREE LAMP

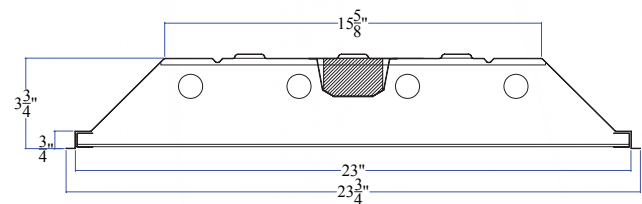
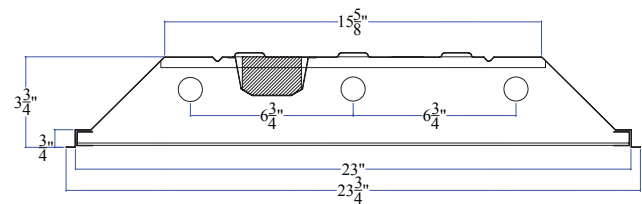

1X4 2 LAMP

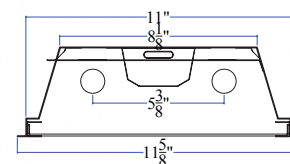

## 2x2 Deep Parabolic Lay-in Troffer



## Applications

Premium 2'x2' recessed deep cell parabolic T-bar troffer designed for maximum efficiency and visual comfort. Ideal for commercial and industrial buildings requiring general illumination with recessed configurations and low glare.

## SPECIFICATIONS

Housing and ends are die-formed from heavy gauge cold rolled steel. Body and the black reveal are highly reflective P3 - Post Powder Paint. Precision formed anodized semi-specular aluminium louver. Standard normal 3" deep cell louvers are manufactured using interlocked construction and mitred corners. Wiring access plate or knockouts are provided on back of housing for flexible conduit attachment. Ballasts cover snaps into place eliminating the need for tools when accessing the ballast. Listed by and bears UL label.

## Features &amp; Benefits

- P3 Technology
- 90% reflectivity
- UL listed for damp location
- Corrosion and scratch resistant
- Smooth edges for easy handling
- Louver manufactured from low iridescent semi specular anodized aluminium
- Shallow design
- Protective plastic dust cover keeps louver clean during shipping and installation
- Black reveal provides gap free coating louver appearance
- Hinges from either side
- Die-formed steel T-hinges
- Positive locking cam action latches
- Air functions - choice of static, air supply or heat removal
- Various cell configurations available
- Access plate for quick wiring
- Equipped with Integral Earthquake clips



## ORDERING DATA

Item #	Description	Old Code	Size (# of Tubes)	Lamp Type/Wattage	Input Voltage	Tubes Included	Diffuser/Lens Type
12221500000	DHGM/2017/EB/UNV ADV C/W 16	05083	2' x 2' - 2 Tube	T8-17W	120-277 VOLTS AC	No	Aluminium Parabolic 16 Cell
12221700000	DHGM/2U32/EB/UNV ADV C/W 9	05094	2' x 2' - 2 Tube	T8 32W U-TUBE	120-277 VOLTS AC	No	Aluminum Parabolic 9 Cell
12221600000	DHGM/2U32/EB/UNV C/W16	05090	2' x 2' - 2 Tube	T8 32W U-TUBE	120-277 VOLTS AC	No	Aluminum Parabolic 16 Cell
12221400000	DHGM/2014/EB/UNV ADV	05072	2' x 2' - 2 Tube	T5-14W	120-277 VOLTS AC	No	Aluminum Parabolic 16 Cell
12877400000	DHGM/2010/LED/65/900LM C/W 16 CELL	DHGM 2010	2' x 2' - 2 Tube	LED-10W-900 LUMEN 6500K	120-277 VOLTS AC	Yes	Aluminium Parabolic 16 Cell
12877700000	DTGM/2010/LED/40/1800LM C/W 9 CELL	DTGM 2020	2' x 2' - 2 Tube	LED-10W-900 LUMEN 4000K	120-277 VOLTS AC	Yes	Aluminum Parabolic 9 Cell
12222200000	DHGM/3017/EB/UNV ADV C/W 9	05190	2' x 2' - 3 Tube	T8-17W	120-277 VOLTS AC	No	Aluminum Parabolic 9 Cell
12221900000	DHGM/3017/EB/UNV/WR/9CELL	05185	2' x 2' - 3 Tube	T8-17W	120-277 VOLTS AC	No	Aluminum Parabolic 9 Cell
12221800000	DHGM/3014/EB/UNV ADV.C/W9	05183	2' x 2' - 3 Tube	T5-14W	120-277 VOLTS AC	No	Aluminum Parabolic 9 Cell
12224200000	DHGM/3014/EB/UNV/C/W 9CELL	5073	2' x 2' - 3 Tube	T5-14W	120-277 VOLTS AC	No	Aluminum Parabolic 9 Cell
12877500000	DHGM/3010/LED/65/900LM C/W 9 CELL	DHGM 3010	2' x 2' - 3 Tube	LED-10W-900 LUMEN 6500K	120-277 VOLTS AC	Yes	Aluminum Parabolic 9 Cell
12222300000	DHGM/4017/EB/UNV ADV C/W 16	05194	2' x 2' - 4 Tube	T8-17W	120-277 VOLTS AC	No	Aluminium Parabolic 16 Cell
12877600000	DHGM/4010/LED/65/900LM C/W 16 CELL	DHGM 4010	2' x 2' - 4 Tube	LED-10W-900 LUMEN 6500K	120-277 VOLTS AC	Yes	Aluminium Parabolic 16 Cell



DIMENSIONS

NOTE:

BACKPLAN

2X2 2 OR 4 LAMP BACKPLAN

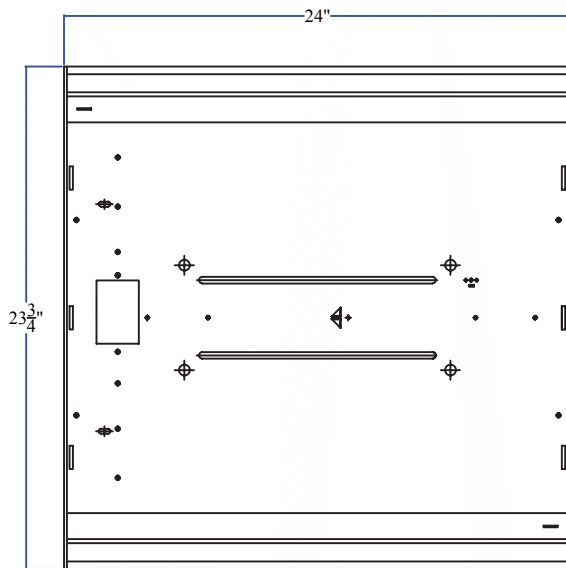

2X2 3 LAMP BACKPLAN

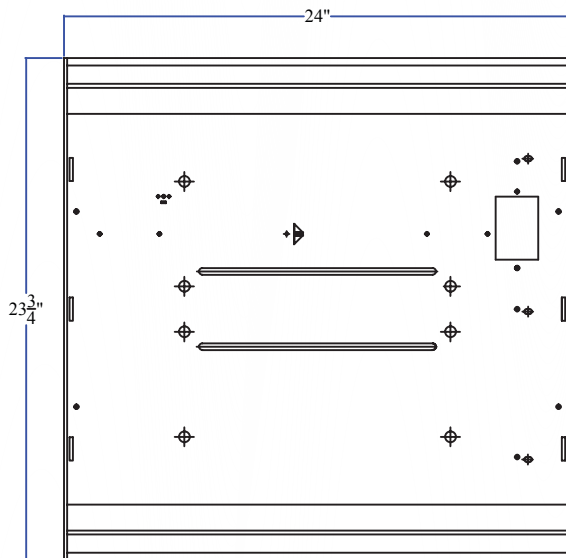

CROSS SECTION

TWO LAMP

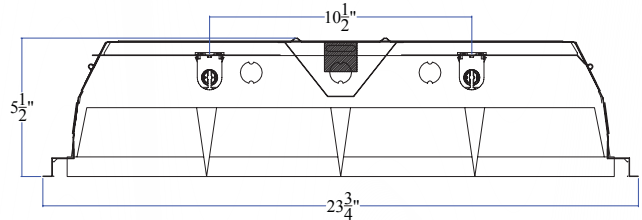

THREE LAMP

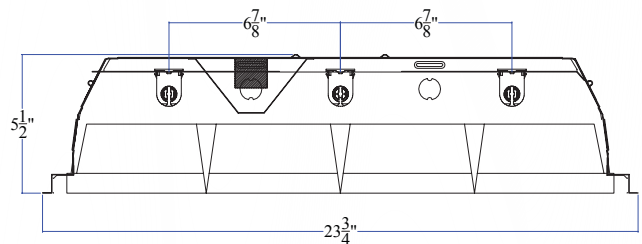

FOUR LAMP

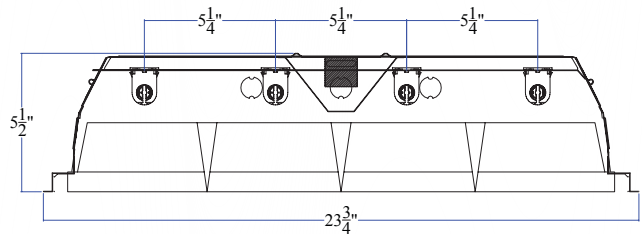

## Deep Parabolic Lay-in Troffer



### Applications

Premium recessed deep cell parabolic T-bar troffer designed for maximum efficiency and visual comfort. Ideal for commercial and industrial buildings requiring general illumination with recessed configurations and low glare.

### SPECIFICATIONS

Housing and ends are die-formed from heavy gauge cold rolled steel. Body and the black reveal are highly reflective P3 - Post Powder Paint. Precision formed anodized semi-specular aluminum louver. Standard normal 3" deep cell louvers are manufactured using interlocked construction and mitred corners. Wiring access plate or knockouts are provided on back of housing for flexible conduit attachment. Ballasts cover snaps into place eliminating the need for tools when accessing the ballast. Listed by and bears UL label.

### Features & Benefits

- > 90% reflectivity
- UL listed for damp location
- Corrosion and scratch resistant
- Smooth edges for easy handling
- Louver manufactured from low iridescent semispecular anodized aluminum
- Shallow design
- Protective plastic dust cover keeps louver clean during shipping and installation
- Black reveal provides gap free coating louver appearance
- Hinges from either side
- Die-formed steel T-hinges
- Positive locking cam action latches
- Air functions - choice of static, air supply or heat removal
- Various cell configurations available
- Access plate for quick wiring
- Equipped with Integral Earthquake Clips
- Every fixture individually tested
- Available in T8, T5, T5HO and LED versions.



### ORDERING DATA

Item #	Description	Old Code	Size (# of Tubes)	Lamp Type/Wattage	Input Voltage	Tubes Included	Diffuser/Lens Type
12222400000	DTGM/2032/EB/UNV/ADV C/W32	06582	2' x 4' - 2 Tube	T8-32W	120-277 VOLTS AC	No	Aluminum Parabolic 32 Cell
12222700000	DTGM/2054/EB/UNV/T5HO C/W32	06590	2' x 4' - 2 Tube	T5-54W HO	120-277 VOLTS AC	Yes	Aluminum Parabolic 32 Cell
12222600000	DTGM/2028/EB/UNV/ADV C/W 32	06589	2' x 4' - 2 Tube	T5-28W	120-277 VOLTS AC	No	Aluminum Parabolic 32 Cell
12888000000	DTGM/2020/LED/65/1800LM C/W 32 CELL	DTGM 2020 C/W32	2' x 4' - 2 Tube	20W-LED-1800-LUMENS-6500K	120-277 VOLTS AC	Yes	Aluminum Parabolic 32 Cell
12222800000	DTGM/3032/EB/UNV C/W 32 CELL	06620	2' x 4' - 3 Tube	T8-32W	120-277 VOLTS AC	No	Aluminum Parabolic 32 Cell
12222900000	DTGM/3032/EB/UNV/ADV/EMG C/W 18C	06626	2' x 4' - 3 Tube	T8-32W	120-277 VOLTS AC	No	Aluminum Parabolic 18 Cell
12223100000	DTGM/3032/EB/UNV/ADVC/W 18 CEL	06650	2' x 4' - 3 Tube	T8-32W	120-277 VOLTS AC	No	Aluminum Parabolic 18 Cell
12223400000	DTGM/3032/EB/UNV/DIM 18 CELL	06680	2' x 4' - 3 Tube	T8-32W	120-277 VOLTS AC	No	Aluminum Parabolic 18 Cell
12223200000	DTGM/3032/EB/UNV/WHT 18CELL	06660	2' x 4' - 3 Tube	T8-32W	120-277 VOLTS AC	No	Aluminum Parabolic 18 Cell
12877800000	DTGM/3020/LED/40/1800LM C/W 18 CELL	DTGM 3020	2' x 4' - 3 Tube	LED-20W-1800-LUMENS-4000K	120-277 VOLTS AC	Yes	Aluminum Parabolic 18 Cell
12888100000	DTGM/3020/LED/65/1800LM C/W 18 CELL	DTGM 3020 CW18	2' x 4' - 3 Tube	20W-LED-1800-LUMENS-6500K	120-277 VOLTS AC	Yes	Aluminum Parabolic 18 Cell
12223800000	DTGM/4032/EB/UNV /NOBOXC/W 32	06772	2' x 4' - 4 Tube	T8-32W	120-277 VOLTS AC	No	Aluminum Parabolic 32 Cell
12223700000	DTGM/4032/EB/UNV/ADV/C/W 18	06766	2' x 4' - 4 Tube	T8-32W	120-277 VOLTS AC	No	Aluminum Parabolic 18 Cell
12223900000	DTGM/4032/EB/UNV/BOX/C/W32	06775	2' x 4' - 4 Tube	T8-32W	120-277 VOLTS AC	No	Aluminum Parabolic 32 Cell
12877900000	DTGM/4020/LED/40/1800LM C/W 32 CELL	DTGM 4020 C/W32	2' x 4' - 4 Tube	LED-20W-1800-LUMENS-4000K	120-277 VOLTS AC	Yes	Aluminum Parabolic 32 Cell
12888200000	DTGM/4020/LED/65/1800LM C/W 32 CELL	DTGM 4020 CW32	2' x 4' - 4 Tube	20W-LED-1800-LUMENS-6500K	120-277 VOLTS AC	Yes	Aluminum Parabolic 32 Cell





## BACKPLAN

2X4 BACKPLAN

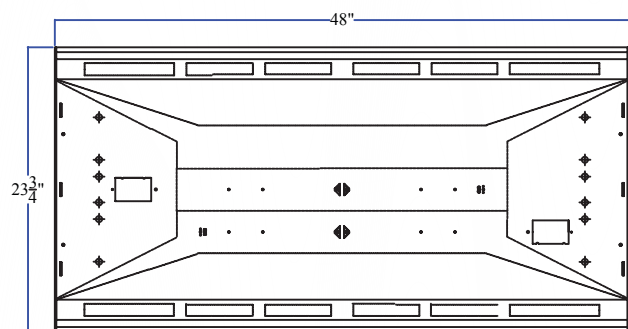

1X4 BACKPLAN

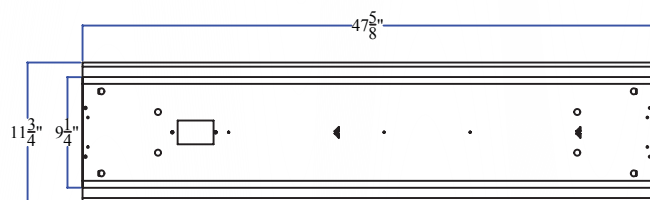

## DIMENSIONS

MODEL CONFIGURATION	A	B	C
1' x 4'	11 3/4"	47 3/4"	48"
2' x 2'	23 3/4"	23 7/8"	24"
2' x 4'	23 3/4"	47 3/4"	48"

## CROSS SECTION

TWO LAMP

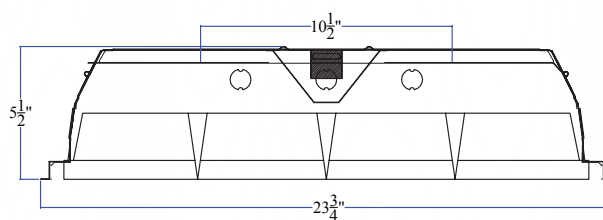

THREE LAMP

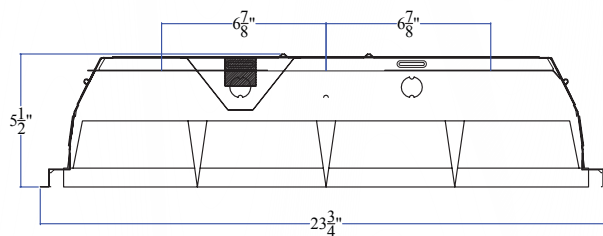

FOUR LAMP

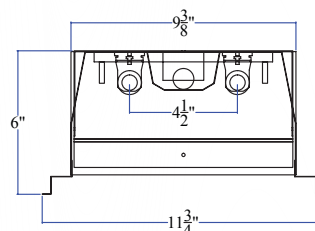
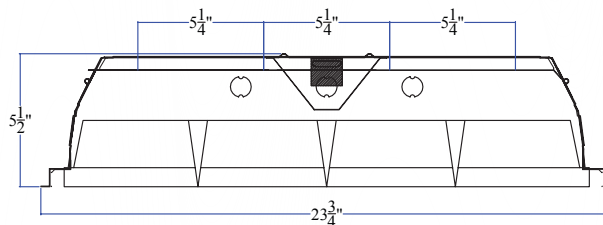

## Direct Indirect Recessed Troffer

## Applications

Premium grade recessed troffer dish with a center basket provides direct/indirect light with modern styling & high visual comfort. For use in commercial & industrial buildings where low glare, high quality, design and ease of installation are required.

## SPECIFICATIONS

Housing is die-formed and spot welded from cold rolled steel. P3 - Post Powder Paint finish in a matte white. Indirect reflectors are precision formed and contoured to provide soft indirect illumination while maintaining high efficiency and wide uniform lighting distribution. Wiring access plate or knockouts are provided on back of housing for flexible conduit attachment. Hole provided for chain mounting support to building structure. Listed by and bears UL label.

## Features &amp; Benefits

- >90% reflectivity
- Corrosion and scratch resistant
- Smooth edges for easy handling
- Contemporary shallow design
- Single basket shaped perforated metal shield
- Translucent opal white acrylic diffuser overlay
- Clean appearance with no exposed fasteners
- Every fixture individually tested
- UL listed for damp location
- Available in T8, T5, T5 HO and LED versions



## ORDERING DATA

Item #	Description	Old Code	Size (# of Tubes)	Lamp Type/Wattage	Input Voltage	Tubes Included	Diffuser/Lens Type
12230100000	DID/2014/EB/UNV ADV C.B	19767	2' x 2' - 2 Tube	T5-14W	120-277 VOLTS AC	No	Micro Ribbed Acrylic Basket
12229100000	DID/2017/EB/UNV ADV C.B.	19765	2' x 2' - 2 Tube	T8-17W	120-277 VOLTS AC	No	Micro Ribbed Acrylic Basket
12234300000	DID/2010/LED/65/900LM		2' x 2' - 2 Tube	LED-10W-900 LUMEN 6500K	120-277 VOLTS AC	Yes	Micro Ribbed Acrylic Basket
12230800000	DID/3017/EB/UNV ADVANCE C.B.	19975	2' x 2' - 3 Tube	T8-17W	120-277 VOLTS AC	No	Micro Ribbed Acrylic Basket
12231000000	DID/3017/EB/UNV DIMMABLE	19983	2' x 2' - 3 Tube	T8-17W	120-277 VOLTS AC	No	Micro Ribbed Acrylic Basket
12231800000	DID/3017/EB/UNV ADVANCE C.B.	21002	2' x 2' - 3 Tube	T8-17W	120-277 VOLTS AC	No	Micro Ribbed Acrylic Basket
12232000000	DID/3014/ES/UNV/T5 C.B	21006	2' x 2' - 3 Tube	T5-14W	120-277 VOLTS AC	No	Micro Ribbed Acrylic Basket
12234400000	DID/3010/LED/65/900LM		2' x 2' - 3 Tube	LED-10W-900 LUMEN 6500K	120-277 VOLTS AC	Yes	Micro Ribbed Acrylic Basket
12232700000	DID/2032/EB/UNV ADV C.B.	19972-K	2' x 4' - 2 Tube	T8-32W	120-277 VOLTS AC	No	Micro Ribbed Acrylic Basket
12230000000	DID/2028/EB/UNV ADV CB T5	19766	2' x 4' - 2 Tube	T5-28W	120-277 VOLTS AC	No	Micro Ribbed Acrylic Basket
12230700000	DID/2032/EB/UNV ADV C.B.	19972	2' x 4' - 2 Tube	T8-32W	120-277 VOLTS AC	No	Micro Ribbed Acrylic Basket
12234500000	DID/2020/LED/40/1800LM		2' x 4' - 2 Tube	LED-20W-1800-LUMENS-4000K	120-277 VOLTS AC	Yes	Micro Ribbed Acrylic Basket
12234700000	DID/2020/LED/65/1800LM		2' x 4' - 2 Tube	20W-LED-1800-LUMENS-6500K	120-277 VOLTS AC	Yes	Micro Ribbed Acrylic Basket
12231900000	DID/2054/ES/UNV/C.B	21005	2' x 4' - 2 Tube		120-277 VOLTS AC	Yes	Micro Ribbed Acrylic Basket
12230600000	DID/3032/ES/UNV DIMMABLE C.B	19968	2' x 4' - 3 Tube	T8-32W	120-277 VOLTS AC	No	Micro Ribbed Acrylic Basket
12231700000	DID/3032/ES/UNV ADVANCE C.B.	21001	2' x 4' - 3 Tube	T8-32W	120-277 VOLTS AC	No	Micro Ribbed Acrylic Basket
12234600000	DID/3020/LED/40/1800LM		2' x 4' - 3 Tube	LED-20W-1800-LUMENS-4000K	120-277 VOLTS AC	Yes	Micro Ribbed Acrylic Basket
12234800000	DID/3020/LED/65/1800LM		2' x 4' - 3 Tube	20W-LED-1800-LUMENS-6500K	120-277 VOLTS AC	Yes	Micro Ribbed Acrylic Basket
12229500000	DID/3054/ES/UNV ADV C.B.	21003	2' x 4' - 3 Tube		120-277 VOLTS AC	Yes	Micro Ribbed Acrylic Basket
12229600000	DID/3028/ES/UNV T5 C.B.	21004	2' x 4' - 3 Tube	T5-28W	120-277 VOLTS AC	No	Micro Ribbed Acrylic Basket





DIMENSIONS

NOTE:

BACKPLAN

2X2 BACKPLAN

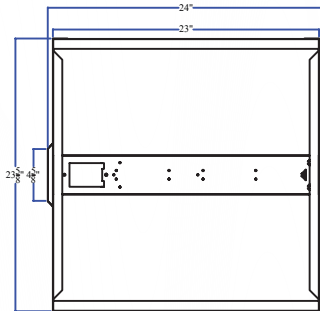

2X4 BACKPLAN

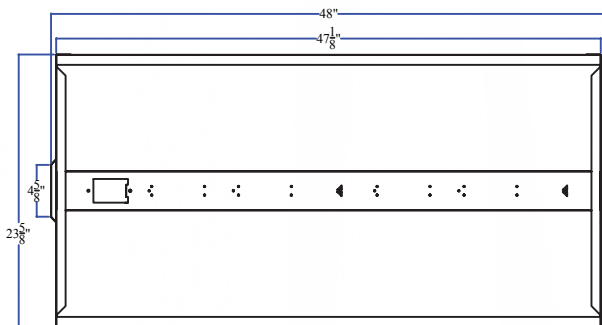

CROSS SECTION

TWO LAMP

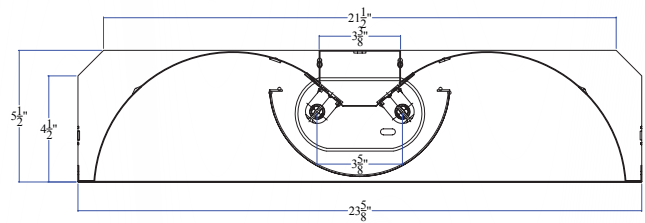

THREE LAMP

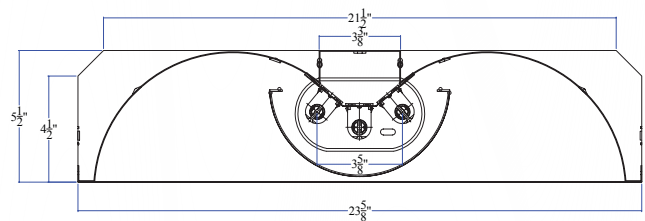

## Swivel End Strip Lighting

## Applications

This line of open slimline fixtures provides the most economical lighting for industrial and commercial applications such as factories, warehouses, workshops, utility areas and public buildings.

## SPECIFICATIONS

Housing and ends are die-formed from cold rolled steel. Finish is high reflectance baked white enamel. Snap-in end plates can serve as joiners for continuous row mounting. Snap-on ballast covers are two piece for simple installation and maintenance. Knockouts are provided for flexible conduit attachment and stem mounting. Mounting holes are provided. Listed by and bears UL label.

## Features &amp; Benefits

- > 90% reflectivity
- UL listed for damp location
- Snap-on components for easy assembly and maintenance
- Combination end plate/coupler can be used for continuous row mounting
- Available in 4', 6', 8' lengths
- Surface, stem or chain mountable
- Available in T8, T5, T5HO and LED versions.



## ORDERING DATA

Item #	Description	Old Code	Size (# of Tubes)	Lamp Type/Wattage	Input Voltage	Tubes Included	Diffuser/Lens Type
12564000000	SES/1032/EB/UNV/60HZ ADV	20397-1	4' - 1 Tube	T8-32W	120-277 VOLTS AC	No	None
12566800000	SES/1032/EB/120V/60HZ ADV	20397	4' - 1 Tube	T8-32W	120 VOLTS AC	No	None
12568300000	SES/2020/LED/65/1800LM		4' - 2 Tube	20W-LED-1800-LUMENS-6500K	120-277 VOLTS AC	Yes	None
12568200000	SES/2020/LED/40/1800LM		4' - 2 Tube	LED-20W-1800-LUMENS-4000K	120-277 VOLTS AC	Yes	None
12566500000	SES/2032/EB/UNV/EMG	20394	4' - 2 Tube	T8-32W	120-277 VOLTS AC	No	None
12566600000	SES/2032/EB/UNV ADV	20395	4' - 2 Tube	T8-32W	120-277 VOLTS AC	No	None
12566700000	SES/2032/EB/120V/60HZ	20396	4' - 2 Tube	T8-32W	120 VOLTS AC	No	None
12567100000	SES/2032/EB/UNV	20425	4' - 2 Tube	T8-32W	120-277 VOLTS AC	No	None
12568000000	SES/2059/EB/UNV CUSTOMER	29019	8' - 2 Tube	T8-59W	120-277 VOLTS AC	No	None
12564400000	SES/2059/EB/UNVCISBALL 8FT COV	29019-1	8' - 2 Tube	T8-59W	120-277 VOLTS AC	No	None
12568400000	SES8FT/4020/LED/UNV/65/1800		8' - 4 Tube	20W-LED-1800 LUMENS	120-277 VOLTS AC	Yes	None
12567200000	SES/4054/EB/UNV	20430	8' - 4 Tube	T5-54W	120-277 VOLTS AC	No	None





DIMENSIONS

NOTE:

ALL FIXTURES 48" IN LENGTH

BACKPLAN

4FT BACKPLAN

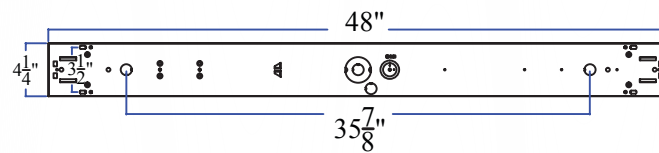

8FT BACKPLAN

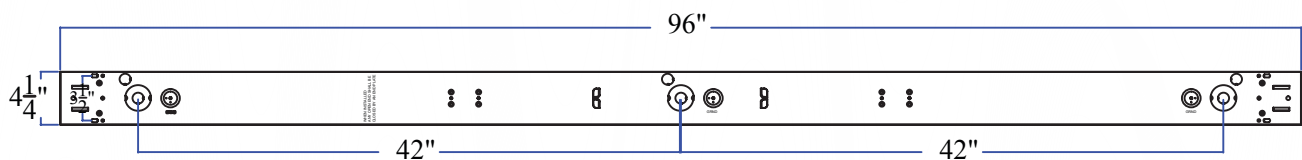

CROSS SECTION

TWO LAMP BI PIN (T8)

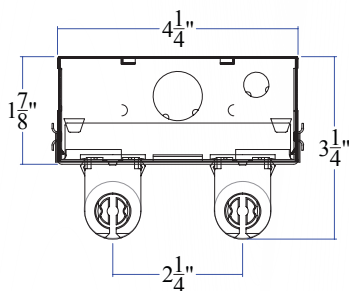

ONE LAMP SINGLE PIN (T8 8FT)

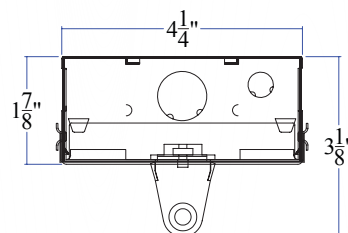

TWO LAMP SINGLE PIN (T8 8FT)

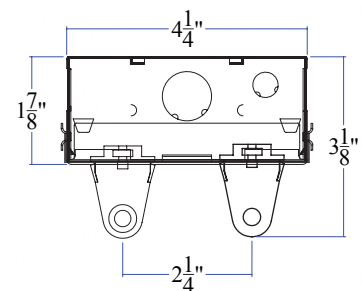

## Slim Line Strip Lighting

## Applications

This attractive cost effective strip light is ideal for industrial and commercial applications such as factories, warehouses, workshops, utility areas and public buildings.

## SPECIFICATIONS

Housing made from die-formed from cold rolled steel. Finish is high reflectance baked white enamel. Snap-in end plates can serve as joiners for continuous row mounting. Sides of body have knockout tabs for side mount tubes on both sides. Socket Bars attach to housing for easy wiring. Ballast cover tucks into tabs on one side and is screwed down on the next for easy maintenance and installation. Listed by and bears UL label.

## Features &amp; Benefits

- UL listed for damp location
- Snap-on components for easy assembly and maintenance
- Snap-in end caps with 1/2" knockouts allows continuous row mounting
- Available in lengths of 24, 36 and 48 inches
- Surface, stem or chain mountable
- Available in T8, T5, T5HO and LED versions.



## ORDERING DATA

Item #	Description	Old Code	Size (# of Tubes)	Lamp Type/Wattage	Input Voltage	Tubes Included	Diffuser/Lens Type
12691900000	SLS/1010/LED/65/900LM		2' - 1 Tube	LED-10W-900 LUMEN 6500K	120-277 VOLTS AC	Yes	None
12690900000	SLS/1014/EB/UNV	20562	2' - 1 Tube	T5-14W	120-277 VOLTS AC	No	None
12690700000	SLS/1017/EB/UNV/ ADVANCE	20559	2' - 1 Tube	T8-17W	120-277 VOLTS AC	No	None
12692000000	SLS/2010/LED/65/900LM		2' - 2 Tube	LED-10W-900 LUMEN 6500K	120-277 VOLTS AC	Yes	None
12691200000	SLS/2017/EB/ UNV	20566	2' - 2 Tube	T8-17W	120-277 VOLTS AC	No	None
12691100000	SLS/1054/EB/UNV	20565	4' - 1 Tube	T5-54W HO	120-277 VOLTS AC	No	None
12692300000	SLS/1020/LED/65/1800LM		4' - 1 Tube	20W-LED-1800-LUMENS-6500K	120-277 VOLTS AC	Yes	None
12692100000	SLS/1020/LED/40/1800LM		4' - 1 Tube	LED-20W-1800-LUMENS-4000K	120-277 VOLTS AC	Yes	None
12691600000	SLS/1028/EB/UNV-T5	20573	4' - 1 Tube	T5-28W	120-277 VOLTS AC	No	None
12690300000	SLS/1032/EB/UNV/ ADVANCE	20555	4' - 1 Tube	T8-32W	120-277 VOLTS AC	No	None
12692400000	SLS/2020/LED/65/1800LM		4' - 2 Tube	20W-LED-1800-LUMENS-6500K	120-277 VOLTS AC	Yes	None
12692200000	SLS/2020/LED/40/1800LM		4' - 2 Tube	LED-20W-1800-LUMENS-4000K	120-277 VOLTS AC	Yes	None
12691300000	SLS/2028/EB/UNV-T5	20567	4' - 2 Tube	T5-28W	120-277 VOLTS AC	No	None
12691000000	SLS/2054/EB/UNV-T5	20563	4' - 2 Tube	T5-54W HO	120-277 VOLTS AC	No	None
12690400000	SLS/2032/EB/UNV/ADVANCE	20556	4' - 2 Tube	T8-32W	120-277 VOLTS AC	No	None



## DIMENSIONS

NOTE:

## BACKPLAN

ONE LAMP

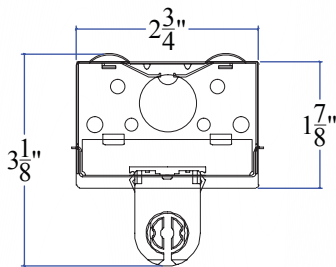

TWO LAMP

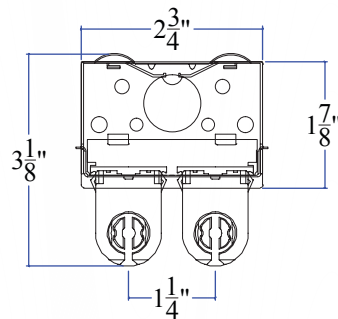

THREE LAMP

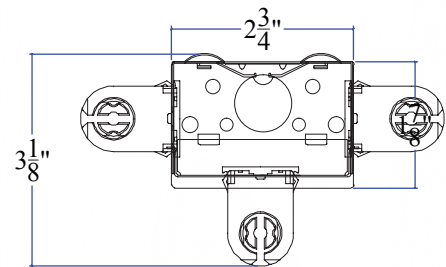

## CROSS SECTION

2 FT BACKPLAN

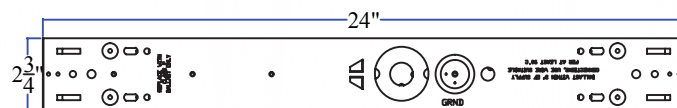

4FT BACKPLAN

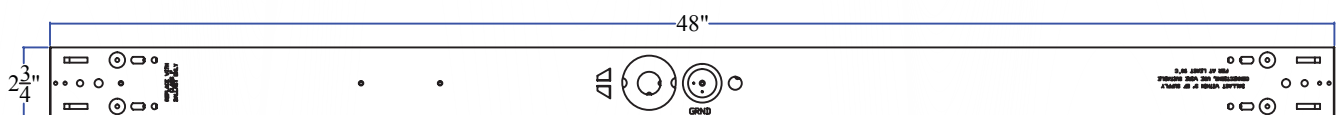



## Surface Mounted Wrap Fixture

### Applications

Economically designed narrow surface mounted fixture provides efficient low glare lighting. Suitable for industrial, commercial and institutional applications such as warehouses, supermarkets and schools. Ideal for both indoor and outdoor uses.

### SPECIFICATIONS

Housing and ends are die-formed from cold rolled steel. Finish is high reflectance P3 - Post Powder Paint. Inspection knockouts provided for mounting to junction box. Ballast cover snaps into place eliminating the need for tools when accessing the ballast. Spring loaded end caps allows easy lamp and ballast replacing. Diffuser is self-centering and snaps into place for easy installation. Knockouts are provided for stem mounting. Listed by and bears UL label.

### Features & Benefits

- > 90% reflectivity
- UL listed for damp location
- Corrosion and scratch resistant
- Smooth edges for easy handling
- Clear acrylic diffuser with prismatic bottom and ribbed linear sides
- Spring loaded ends allow for easy maintenance
- Available in lengths from 24 and 48 inches - (2' & 4' lengths)
- Single or continuous row mounting capability
- Surface, stem or chain mountable
- Every fixture individually tested
- Available in T8, T5, T5HO and LED versions.



### ORDERING DATA

Item #	Description	Old Code	Size (# of Tubes)	Lamp Type/Wattage	Input Voltage	Tubes Included	Diffuser/Lens Type
12178200000	BP/2032/EB/UNI ADVANCE	03561	4' - 2 Tube	T8-32W	120-277 VOLTS AC	No	Wraparound Acrylic
12178300000	BP/2054/EB/UNV/60HZ T5	03600	4' - 2 Tube	T5-54W	120-277 VOLTS AC	No	Wraparound Acrylic
12178000000	BP/2017/EB/120V/ ADVANCE	03405	2' - 2 Tube	T8-17W	120 VOLTS AC	No	Wraparound Acrylic
12178100000	BP/2017/EB/UNI ADVANCE	03415	2' - 2 Tube	T8-17W	120-277 VOLTS AC	No	Wraparound Acrylic



## DIMENSIONS

NOTE:

## BACKPLAN

2 FT BACKPLAN

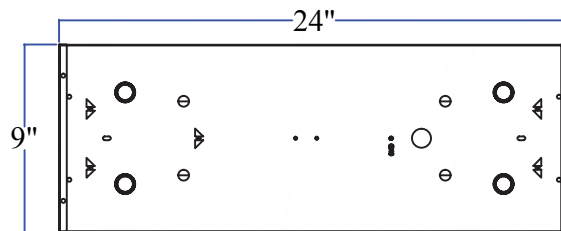

4FT BACKPLAN

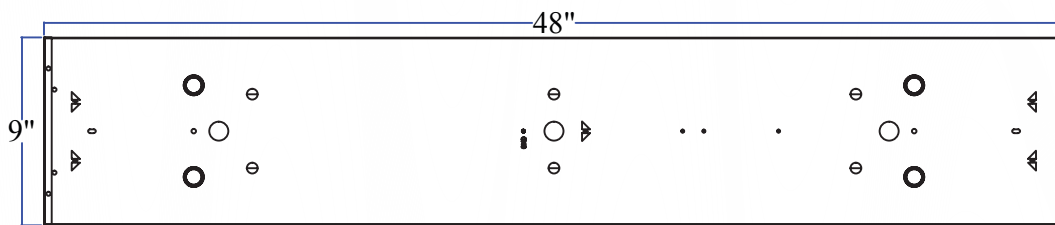

## CROSS SECTION

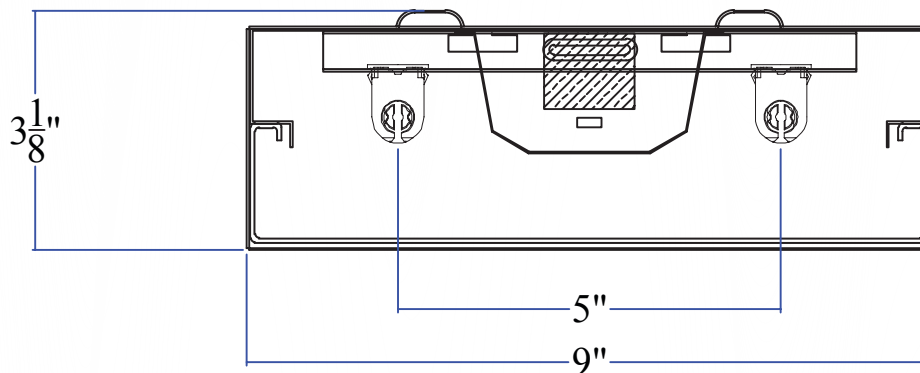

### Applications

Economically designed narrow wraparound provides reliable and efficient lighting. Ideal for use in indoor applications such as homes, modular homes, mobile homes, stores and public building where low glare and ease of installation is required.

### SPECIFICATIONS

Housing and ends are die-formed and embossed from cold rolled steel. Finish is high reflectance P3 - Post Powder Paint. Inspection knockouts provided for mounting to junction box. Ballast cover snaps into place eliminating the need for tools when accessing the ballast. Diffuser hinges from either side in a lift and shift manner and is self-centering. End caps may be butted together for continuous row mounting. Narrow design provides spacing for cooler operation. Knockouts are provided for stem mounting. Listed by and bears UL label.

### Features & Benefits

- > 90% reflectivity
- UL listed for damp location
- Corrosion and scratch resistant
- Smooth edges for easy handling
- Nominal 9" width with a shallow design
- Clear acrylic diffuser with prismatic bottom and ribbed linear sides
- Diffuser self-aligns and hinges from either side for easy maintenance
- Available in lengths from 24 to 48 inches - (2' & 4' lengths)
- Standard two lamp configuration
- Easy re-lamping and re-ballasting
- Single or continuous row mounting capability
- Surface, stem or chain mountable
- Every fixture individually tested



### ORDERING DATA

Item #	Description	Old Code	Size (# of Tubes)	Lamp Type/Wattage	Input Voltage	Tubes Included	Diffuser/Lens Type
12883900000	WRAP/2010/LED/65/900LM		2' - 2 Tube	LED-10W-900 LUMEN 6500K	120-277 VOLTS AC	Yes	Wraparound Acrylic
12883200000	WRAP/2014/EB/UNV	03618	2' - 2 Tube	T5-14W	120-277 VOLTS AC	No	Wraparound Acrylic
12883800000	WRAP/2017/EB/120V/ADV/WITH DIFFER	03613	2' - 2 Tube	T8-17W	120 VOLTS AC	No	Wraparound Acrylic
12884100000	WRAP/2020/LED/65/1800LM		4' - 2 Tube	20W-LED-1800-LUMENS-6500K	120-277 VOLTS AC	Yes	Wraparound Acrylic
12884000000	WRAP/2020/LED/40/1800LM		4' - 2 Tube	LED-20W-1800-LUMENS-4000K	120-277 VOLTS AC	Yes	Wraparound Acrylic
12882900000	WRAP/2028/EB/UNV/ADV/WITHDIFF	03615	4' - 2 Tube	T5-28W	120-277 VOLTS AC	No	Wraparound Acrylic
12882400000	WRAP/2032/EB/UNV/EMG WITHDIFF	03603	4' - 2 Tube	T8-32W	120-277 VOLTS AC	No	Wraparound Acrylic
12882500000	WRAP/2032/EB/120V/60HZ WD	03606	4' - 2 Tube	T8-32W	120 VOLTS AC	No	Wraparound Acrylic
12882600000	WRAP/2032/EB/UNV/ADV/WITH DIFF	03611	4' - 2 Tube	T8-32W	120-277 VOLTS AC	No	Wraparound Acrylic
12881400000	WRAP/2032/EB/UNV	WRAP 2032	4' - 2 Tube	T8-32W	120-277 VOLTS AC	No	Wraparound Acrylic





DIMENSIONS

MODEL CONFIGURATION	A
2 FT	24"
4 FT	48"
6 FT	96"

BACKPLAN

2 FT BACKPLAN

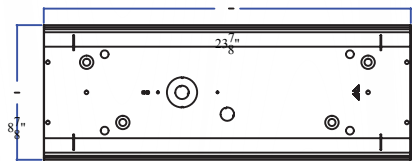

4FT BACKPLAN

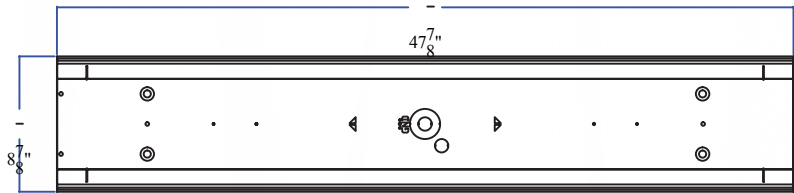

CROSS SECTION

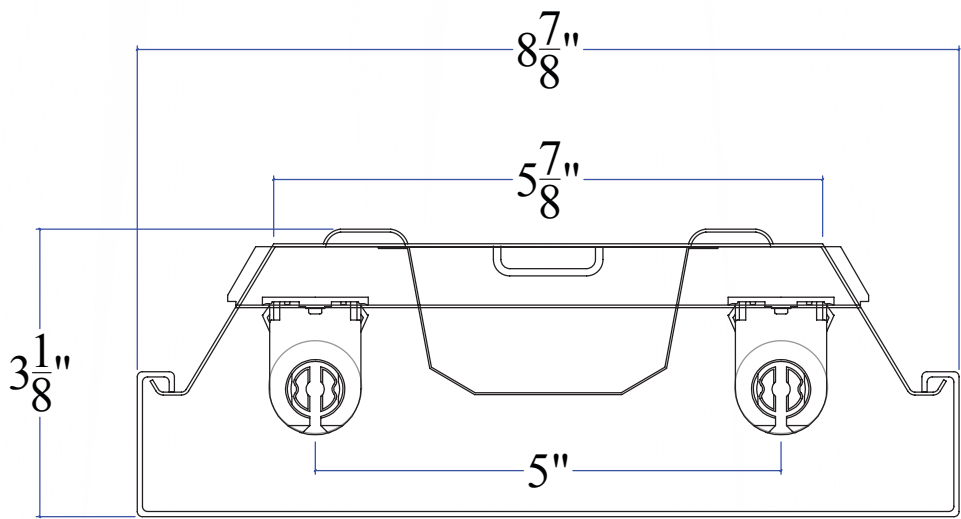

### SPECIFICATIONS

Housing and ends are die-formed from cold rolled steel. Finish is high reflectance baked white enamel. Ballast cover snaps into place eliminating the need for tools when accessing the ballast. Diffuser hinges from either side in a lift and shift manner and is self-centering. Listed by and bears UL label.

### Applications

Premium grade surface mounted wraparound luminaire with low brightness linear sides. For use in indoor applications where high efficiency, high performance and ease of installation is required. Ideal for retail stores, stairwells, utility areas, schools, offices and public buildings.

### Features & Benefits

- > 90% reflectivity
- UL listed for damp location
- Nominal 15" wraps
- Clear acrylic diffuser with prismatic bottom and ribbed linear sides
- Diffuser self-aligns and hinges from either side for easy maintenance
- Available in multiple lamp configurations
- Surface, stem or chain mountable
- Single or continuous row mounting capability
- Every fixture individually tested
- Available in T8, T5, T5HO and LED versions.



### ORDERING DATA

Item #	Description	Old Code	Size (# of Tubes)	Lamp Type/Wattage	Input Voltage	Tubes Included	Diffuser/Lens Type
12883400000	WRAP/4032/EB/UNV/ADV WITHDIF	03856	4' - 4 Tube	T8-32W	120-277 VOLTS AC	No	Wraparound Acrylic



DIMENSIONS

MODEL CONFIGURATION	A
4 FT	48"

BACKPLAN

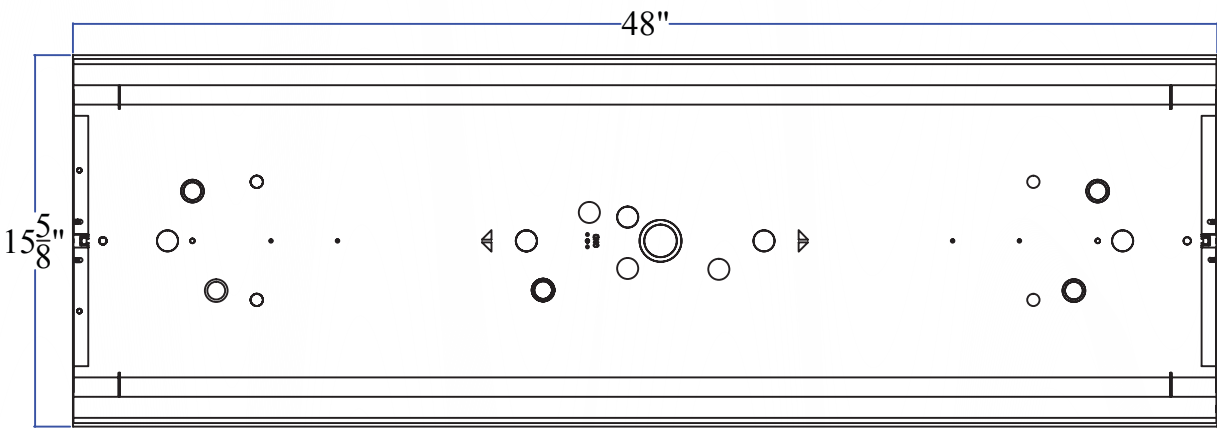

CROSS SECTION

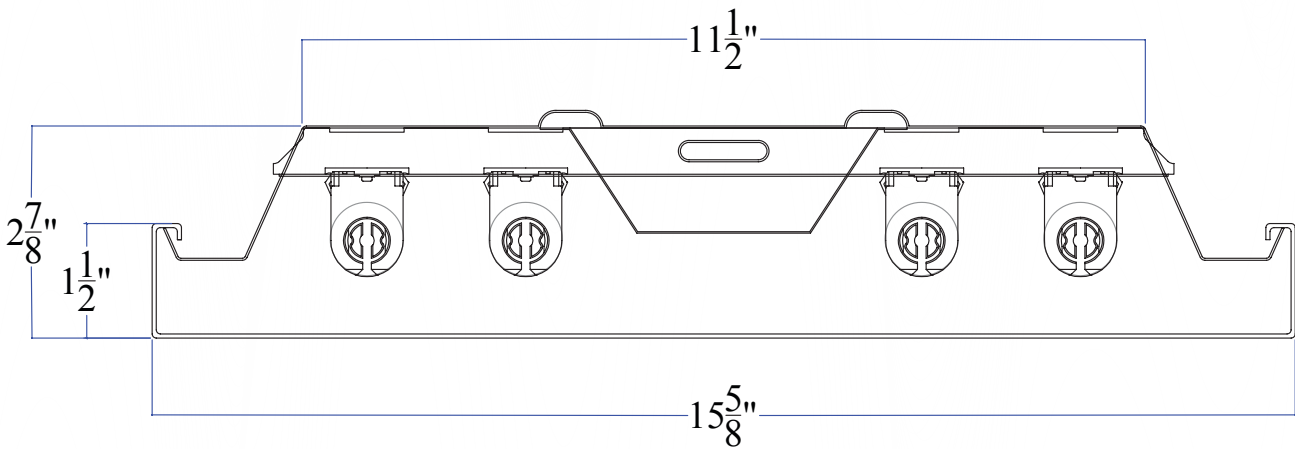



## Deep Profile Wraparound Fixture

### Applications

Surface mounted wraparound unit suitable for use in most commercial, residential and institutional type applications. The unit provides maximum light output with minimum clearance.

### SPECIFICATIONS

Housing and ends are die-formed from cold rolled steel. Finish is high reflectance P3 - Post Powder Paint. Inspection knockouts provided for mounting to junction box. Clear acrylic prismatic wrap around diffuser hinges from both sides and snaps on and off for easy maintenance. Unit is equipped with knockouts and holes for pendant or surface mounting. This fixture can be mounted individually or on a continuous row. Listed by and bears UL label.

### Features & Benefits

- > 90% reflectivity
- UL listed for damp location
- Corrosion and scratch resistant
- Smooth edges for easy handling
- Clear acrylic wrap diffuser with prismatic bottom and ribbed linear sides
- Snap in socketbars allows for easy maintenance
- Available in lengths from 48 and 96 inches - (4' & 8' lengths)
- Single or continuous row mounting capability
- Surface or stem mountable
- Every fixture individually tested
- Available in T8, T5, T5HO and LED versions.



### ORDERING DATA

Item #	Description	Old Code	Size (# of Tubes)	Lamp Type/Wattage	Input Voltage	Tubes Included	Diffuser/Lens Type
12299300000	DW/8FT/4032/EB/UNV/ADV	19637	8' - 4 Tube	T8-32W	120-277 VOLTS AC	No	Acrylic Wrap Around
12184600000	DW/2032/EB/UNV/ADV	19639	4' - 2 Tube	T8-32W	120-277 VOLTS AC	No	Acrylic Wrap Around



DIMENSIONS

NOTE:

BACKPLAN

4FT BACKPLAN

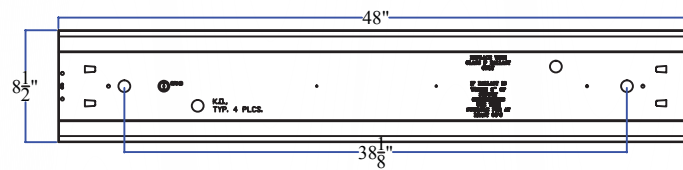

8FT BACKPLAN

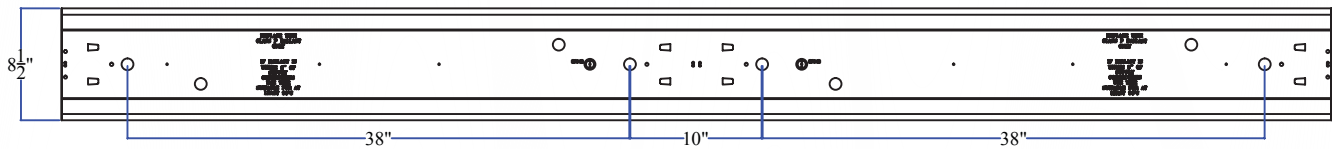

CROSS SECTION

TWO LAMP

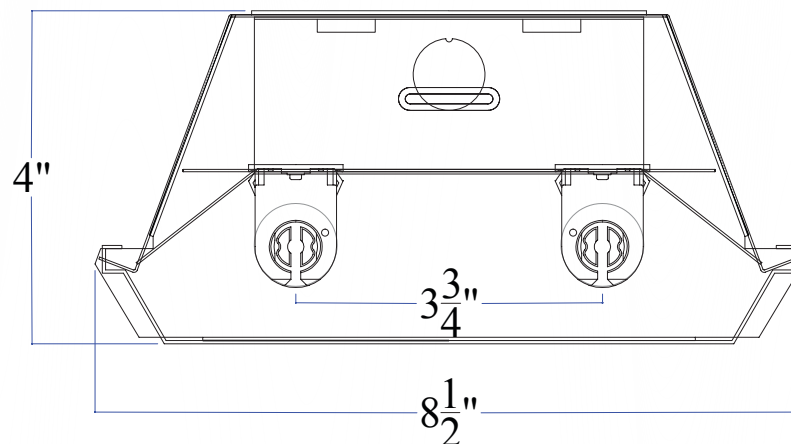

### Applications

A corrosion proof fluorescent fixture designed for parking garages, food handling areas, cold storage and any application where bugs, vapours, moisture, and dirt are a problem.

### SPECIFICATIONS

Fixture housing constructed from resilient and long lasting plastic. The injection moulded poly carbonate lens is clamped firmly to the housing with ten trouble-free plastic latches. The unit is completely gasketed with a neoprene gasket continuously bonded to housing. Units may be surface or pendant mounted.

### Features & Benefits

- Corrosion and scratch resistant
- Dust and moisture resistant
- Available in lengths from 24 and 48 inches - (2' & 4' lengths)
- High impact resistant poly carbonate diffuser held with positive plastic latches
- Continuous poured in place gasket
- No joints to open
- Available in T5 and T8 for long term energy savings
- Comes with gear tray to ease installation in the field



### ORDERING DATA

Item #	Description	Old Code	Size (# of Tubes)	Lamp Type/Wattage	Input Voltage	Tubes Included	Diffuser/Lens Type
12876300000	VP/1010/LED/65/900LM		2' - 1 Tube	LED-10W-900 LUMEN 6500K	120-277 VOLTS AC	Yes	Clear Polycarbonate
12874800000	VP/1017/EB/UNV/ADV	18285	2' - 1 Tube	T8-17W	120-277 VOLTS AC	No	Clear Polycarbonate
12876400000	VP/2010/LED/65/900LM		2' - 2 Tube	LED-10W-900 LUMEN 6500K	120-277 VOLTS AC	Yes	Clear Polycarbonate
12874900000	VP/2017/EB/UNV/ADV	18290	2' - 2 Tube	T8-17W	120-277 VOLTS AC	No	Clear Polycarbonate
12875000000	VP/2017/EB/120V/60HZ	18295	2' - 2 Tube	T8-17W	120 VOLTS AC	No	Clear Polycarbonate
12876700000	VP/1020/LED/65/1800LM		4' - 1 Tube	20W-LED-1800-LUMENS-6500K	120-277 VOLTS AC	Yes	Clear Polycarbonate
12876500000	VP/1020/LED/40/1800LM		4' - 1 Tube	LED-20W-1800-LUMENS-4000K	120-277 VOLTS AC	Yes	Clear Polycarbonate
12877100000	VP/1028/EBUNV	18372	4' - 1 Tube	T5-28W	120-277 VOLTS AC	No	Clear Polycarbonate
12876100000	VP/1032/EB/UNV/ADV	18180	4' - 1 Tube	T8-32W	120-277 VOLTS AC	No	Clear Polycarbonate
12876800000	VP/2020/LED/65/1800LM		4' - 2 Tube	20W-LED-1800-LUMENS-6500K	120-277 VOLTS AC	Yes	Clear Polycarbonate
12876600000	VP/2020/LED/40/1800LM		4' - 2 Tube	LED-20W-1800-LUMENS-4000K	120-277 VOLTS AC	Yes	Clear Polycarbonate
12875400000	VP/2028/EB/UNV/ADV ( T5	18371	4' - 2 Tube	T5-28W	120-277 VOLTS AC	No	Clear Polycarbonate
12875800000	VP/2054/EB/UNV ( T5)/HO	18565	4' - 2 Tube	T5-54W HO	120-277 VOLTS AC	No	Clear Polycarbonate
12875100000	VP/2032/EB/120V/60HZ/ADV	18340	4' - 2 Tube	T8-32W	120 VOLTS AC	No	Clear Polycarbonate
12875300000	VP/2032/EB/UNV/ ADV	18370	4' - 2 Tube	T8-32W	120-277 VOLTS AC	No	Clear Polycarbonate





## DIMENSIONS

NOTE:

## BACKPLAN

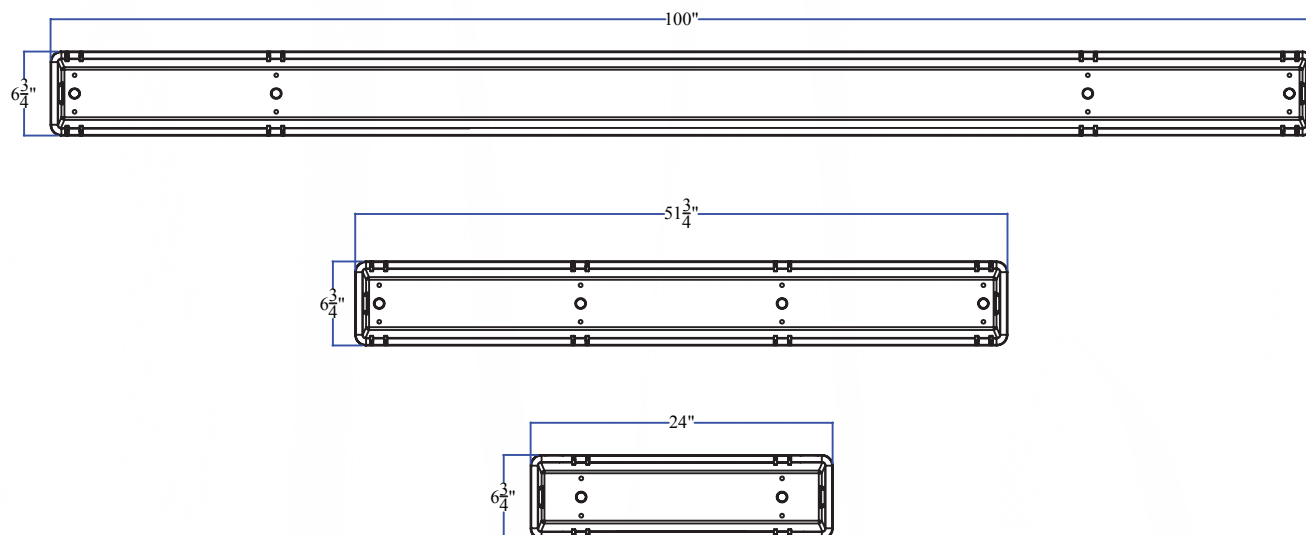

## CROSS SECTION

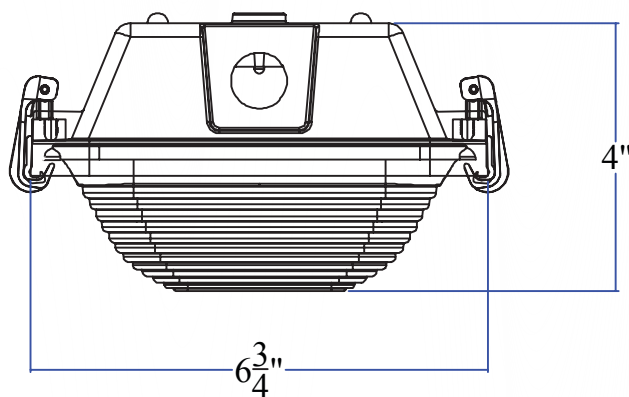

## Vapour Proof Premium

## Applications

Premium grade enclosed and gasketed fluorescent fixture. For use in both indoor and outdoor applications where dust and water resistance is required. Ideal for marinas, barns, canopies, car washes, poultry farms, agricultural applications and other areas susceptible to corrosive conditions.

## SPECIFICATIONS

High quality enclosed fiberglass fixture features a unique continuous poured gasket which completely fills channel for maximum seal integrity. Diffuser is held in place with retaining latches. Hole is 7/8" diameter and is provided with a plastic plug on one end for conduit attachment. Offset mounting pads which keep luminaire level and leaves clearance between fixture and mounting surface are formed within the housing. Highly reflective coated interior surface improves efficiency. Standard diffuser is high impact acrylic with textured pattern designed for high efficiency while providing reduced glare. Listed by and bears UL label.

## Features &amp; Benefits

- Dust and moisture resistant
- Virtually unbreakable fiberglass housing provides superior corrosion resistance
- Comes with optional stainless steel latches
- Optional stainless steel mounting bracket with bail
- Available in lengths from 24 to 96 inches - (2', 4', 8' lengths)
- White molded end plugs snap and lock to maintain tight seal of unused end holes
- 100% high impact resistant acrylic diffuser held with positive cam latches
- Continuous poured in place gasket
- No joints to open
- Available in T5 and T8 for long term energy savings
- Comes with gear tray to ease installation in the field
- UL listed for wet location
- Available in T8, T5 and T5HO versions



## ORDERING DATA

Item #	Description	Old Code	Size (# of Tubes)	Lamp Type/Wattage	Input Voltage	Tubes Included	Diffuser/Lens Type
12877200000	VPP/2032/EB/UNV	VPP/2032/EB/UNV	4' - 2 Tube	T8-32W	120-277 VOLTS AC	No	Impact Resistant Acrylic
12876200000	VPP/2054/EB/UNV	18365	4' - 2 Tube	T5-54W HO	120-277 VOLTS AC	No	Impact Resistant Acrylic



## DIMENSIONS

NOTE:

## BACKPLAN

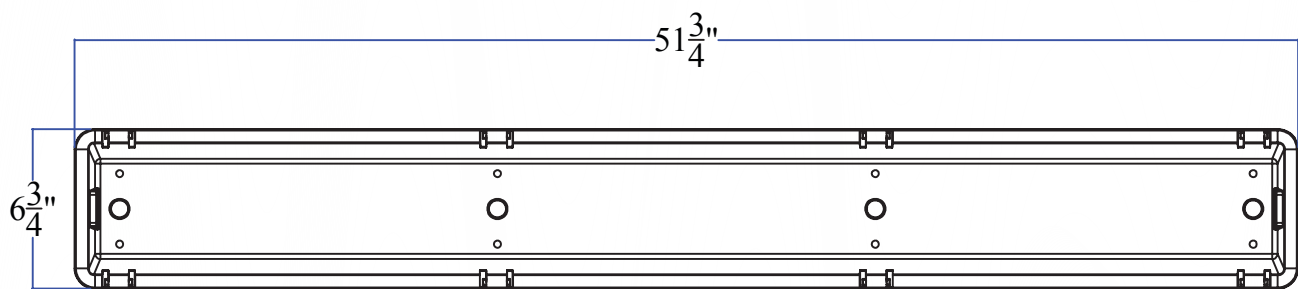

## CROSS SECTION

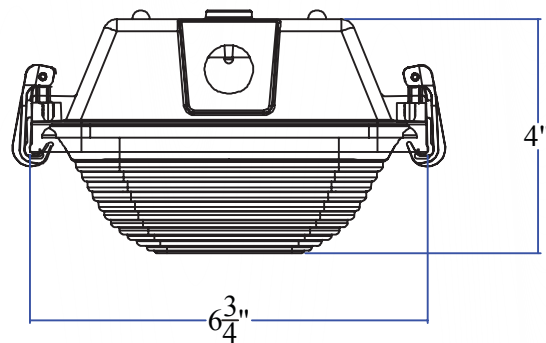

## Vapour Proof Wet Location

## Applications

A very tough enclosure for demanding environments. For use in both indoor and outdoor applications where dust and water resistance is required. Ideal for refrigerated storage, food processing facilities, beverage and bottling facilities, exterior retail, construction sites and gymnasiums.

## Features &amp; Benefits

- Protects your lighting in demanding environments
- Entry holes for 1/2" NPT/M20 fittings
- Optional hole in 1 end or holes in both ends
- Optional silver MIRO 4 reflector provides 94% reflectivity
- Cable or V-hook mounting
- Very durable
- Easy to clean and service
- Stainless steel hardware
- Impact resistant lenses
- 4 and 6 lamp configurations
- RoHS Compliant
- UL listed for wet location
- Available in T8, T5 and T5HO versions
- IP 67 Rated



## SPECIFICATIONS

The hybrid vaportite fluorescent highbay is versatily designed for T5HO and T8 technology. Geartrays are die formed from cold rolled steel with a minimum 87% total reflectance, or achieve 94% reflectivity with our optional MIRO 4 reflector. Supported by 4 stainless steel spring fittings, the fixture can be opened or latched from either side for easy installation and maintenance. The stainless steel latches provide durability and chemical resistance. The captive design of the latch will not allow it to dry off during maintenance. There are twelve latches per unit to assure positive lens retention, which can be made tamper resistant. Lenses are made of 100% impact resistant acrylic for maximum light transmission and longevity or UV stabilized polycarbonate for temperature extremes and maximum impact resistance. The face side of the lens is glass clear to maximize efficiency and minimize distortion of reflectors intended distribution. The sides have precise lineal prisms and the ends are lightly frosted to reduce direct glare. Easily mounted with V-hooks or cables. No holes need to be drilled through the housing. Stainless steel V-hooks with hook hangers are available and are UL rated for 4 times fixture weight. Cable hangers are compatible with cable systems for easy installation. Appropriate for those applications that may require: washability/hose down, complete containment of the lamps, the ability to withstand reduced temperatures and withstand moderate impact. Seals dust out. Reflectance of interior surfaces will not be affected by environmental containments. Designed for easy assembly and maintenance. Listed by and bears UL wet label.

## ORDERING DATA

Item #	Description	Old Code	Size (# of Tubes)	Lamp Type/Wattage	Input Voltage	Tubes Included	Diffuser/Lens Type
12875700000	VPWL/4054/EB/120/277V/T5 HO	18391	4' - 4 Tube	T5 HO- 54W	120-277 VOLTS AC	No	Impact Resistant Acrylic
12875600000	VPWL/6054/EB/120/277V/T5 HO	18390	4' - 6 Tube	T5 HO- 54W	120-277 VOLTS AC	No	Impact Resistant Acrylic





DIMENSIONS

MODEL CONFIGURATION	A	B	C
	51.91"	14.61"	5.95"

BACKPLAN

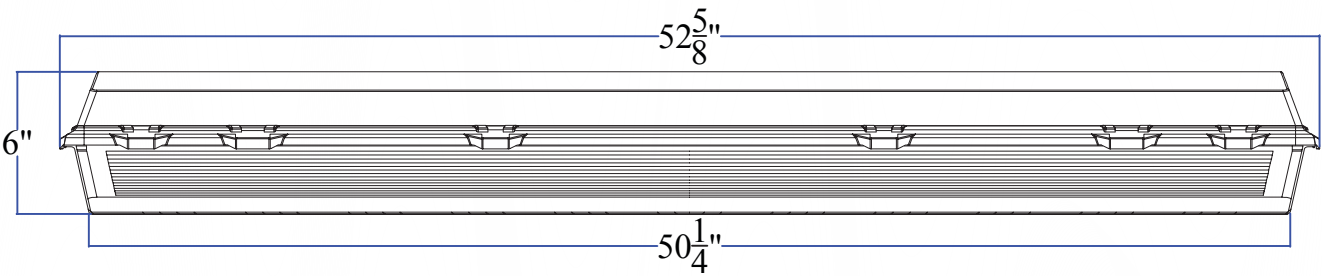

CROSS SECTION

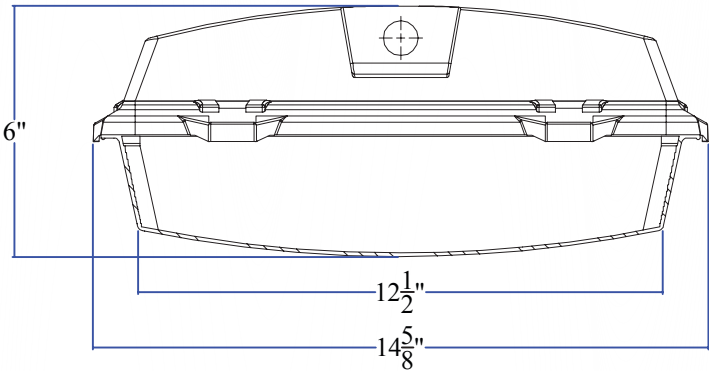

## SES Fluorescent High Bay

## Applications

Modern technology and design produced the strip T5 highbay which is excellent for areas requiring high levels of illumination. This energy efficient substitute for HID is ideal for retail, warehouse, commercial and manufacturing areas.

## SPECIFICATIONS

Housing is standard 22 gauge die-formed cold rolled steel with P3 - Post Powder Paint. Reflector is specular anodized MIRO 4 aluminum. Fixtures are to be stem or chain mounted. Listed by and bears the UL label.

## Features &amp; Benefits

- UL listed for damp location
- >90% reflectivity
- Corrosion and scratch resistant
- Smooth edges for easy handling
- Up to 50% energy savings compared to equivalent metal halide luminaire
- Improved light output and greater color rendition than HID
- The shallow dimensions allow for fixture mounting close to the ceiling minimizing damage and offering the best space utilization
- Available in 48 inches - (4' length)
- Can be stem or chain mounted
- Standard MIRO 4 reflector provides 94% reflectivity
- Instant re-strike capability
- Every fixture is individually tested
- Available in T8, T5, T5HO and LED versions.



## ORDERING DATA

Item #	Description	Old Code	Size (# of Tubes)	Lamp Type/Wattage	Input Voltage	Tubes Included	Diffuser/Lens Type
12564000000	SES/1032/EB/UNV/60HZ ADV	20397-1	4' - 1 Tube	T8-32W	120-277 VOLTS AC	No	None
12566800000	SES/1032/EB/120V/60HZ ADV	20397	4' - 1 Tube	T8-32W	120 VOLTS AC	No	None
12568300000	SES/2020/LED/65/1800LM		4' - 2 Tube	20W-LED-1800-LUMENS-6500K	120-277 VOLTS AC	Yes	None
12568200000	SES/2020/LED/40/1800LM		4' - 2 Tube	LED-20W-1800-LUMENS-4000K	120-277 VOLTS AC	Yes	None
12566500000	SES/2032/EB/UNV/EMG	20394	4' - 2 Tube	T8-32W	120-277 VOLTS AC	No	None
12566600000	SES/2032/EB/UNV ADV	20395	4' - 2 Tube	T8-32W	120-277 VOLTS AC	No	None
12566700000	SES/2032/EB/120V/60HZ	20396	4' - 2 Tube	T8-32W	120 VOLTS AC	No	None
12567100000	SES/2032/EB/UNV	20425	4' - 2 Tube	T8-32W	120-277 VOLTS AC	No	None
12568000000	SES/2059/EB/UNV CUSTOMER	29019	8' - 2 Tube	T8-59W	120-277 VOLTS AC	No	None
12564400000	SES/2059/EB/UNVCISBALL 8FT COV	29019-1	8' - 2 Tube	T8-59W	120-277 VOLTS AC	No	None
12568400000	SES8FT/4020/LED/UNV/65/1800		8' - 4 Tube	20W-LED-1800 LUMENS	120-277 VOLTS AC	Yes	None
12567200000	SES/4054/EB/UNV	20430	8' - 4 Tube	T5-54W	120-277 VOLTS AC	No	None

DIMENSIONS

NOTE:

ALL FIXTURES 48" IN LENGTH

BACKPLAN

FOUR LAMP BACKPLAN

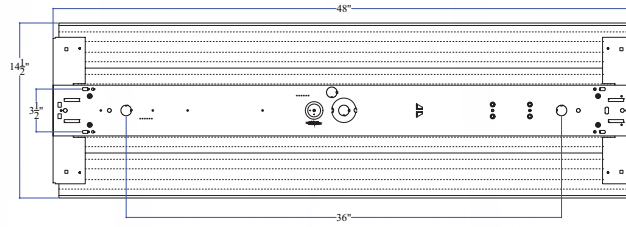

SIX LAMP BACKPLAN

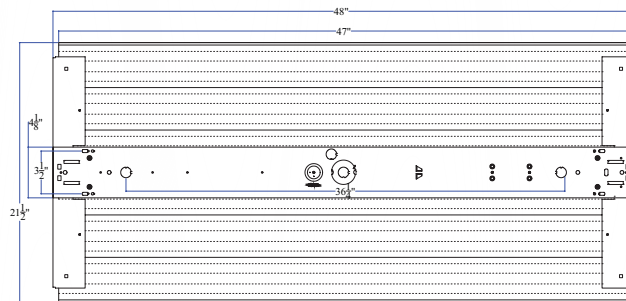

CROSS SECTION

FOUR LAMP CROSS SECTION

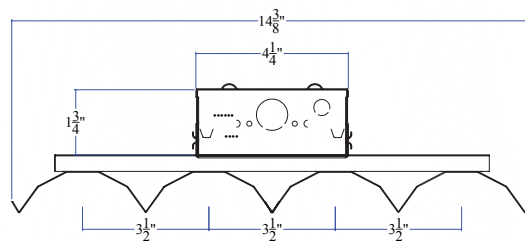

SIX LAMP CROSS SECTION

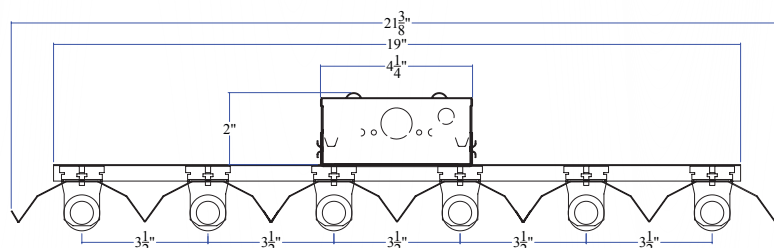



**ELECTRICAL  
INDUSTRIES**  
GROUP



**ADDRESS (Headoffice)**

#1 Century Drive,  
Trincity Industrial Estate,  
Macoya, Tunapuna,  
Trinidad, West Indies

**ADDRESS (Mailing):**

P.O. Box 808

**CONTACT:**

868-223-1294 || Phone

868-645-6161 || Fax

[info@electricalindustriesgroup.com](mailto:info@electricalindustriesgroup.com) || Email

[www.electricalindustriesgroup.com](http://www.electricalindustriesgroup.com) || Web